

# Indicator

17-  
2A035W

Distribution by  
Farnell



<https://farnell.eao.com/p/17-2A035W>

Your product:

---



## 17-2A035W Indicator

### FRONT

Front dimension:	Ø 16 mm
Front form:	Round
Reflector:	Metal, polished chromium-plated

### MOUNTING

Design:	Raised
Mounting cut-out:	Ø 14 mm
Mounting type:	Panel mounting

### OPERATING-/INDICATION PART

Lens:	round
Illumination colour:	White

### ELECTRICAL CHARACTERISTICS

Operating voltage:	24 V AC/DC
Operation current:	9 - 17 mA ±15 %
Lumi. Intensity:	1350 mcd
Polarity:	Anode (+) Brass plug-in connector Cathode (-) Brass tinned plug-in connector

### MECHANICAL CHARACTERISTICS

Terminal:	Plug-in terminal, 2.8 x 0.8 mm
Tightening torque:	Fixing nut max. 0.2 Nm

**Weight:** 0.014 kg

## **AMBIENT CONDITION**

**IP Protection:** IP40 front side, IP65 front side, according to IEC 60529

**Operating temperature:** – 20 °C ... + 60 °C

**Storage temperature:** – 25 °C ... + 80 °C

## **CERTIFICATE**

**Approbations:** UL

**Conformities:** 2011 / 65 / EC (RoHS), 2014 / 35 / EU (230 VAC)

**REACH:** REACH compliant

**RoHS:** RoHS compliant

## **OTHER**

**Short Description:** Indicator, Ø 14 mm, Ø 16 mm, Round, Plug-in terminal, 2.8 x 0.8 mm, White

**Kind of illumination:** Single-LED

**Product attributes:** Sunlight visibility

**Hints:** Connectors: Brass terminal = anode (+); brass tinned terminal = cathode (-), IP67 front side gap between LED and reflector and gap between reflector and frontplate sealed to IP67 when using the supplied gasket., The plastic is limited resistant to chemicals.

**Wiring diagrams:**



Mounting cut-outs:

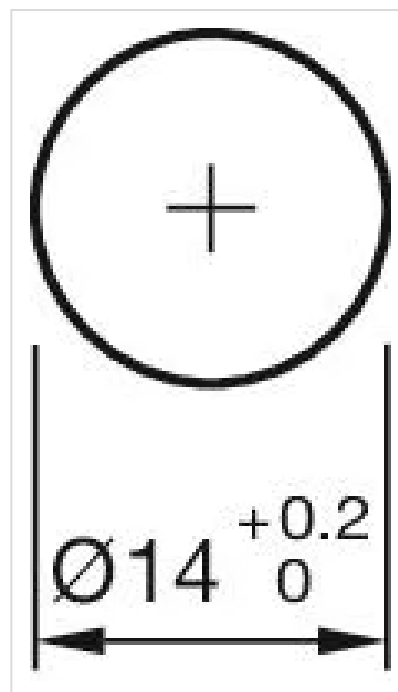

Dimension drawings:



A = Protection tube (only 230 VAC)

B = Tri-colour