

Actuator

18-
082.0055L

Distribution by
Farnell



<https://farnell.eao.com/component/18-082.0055...>

Your product:



18-082.0055L
Actuator

PRODUCT RANGE

Product Status: Phase-out

FRONT

Front dimension: 19 mm x 19 mm

Front form: Square

Front bezel colour: Black

Front bezel material: Plastic

MOUNTING

Design: Flush

Mounting type: Panel mounting

OPERATING-/INDICATION PART

Lens colour: Green

Lens material: Plastic

Lens illumination: Illuminated

Lens shape: Flush

Lens optics: translucent

Illumination colour: Green

ELECTRICAL CHARACTERISTICS

Operating voltage: 24 V DC \pm 10 %

MECHANICAL CHARACTERISTICS

Terminal: Soldering terminal

Weight: 0.003 kg

AMBIENT CONDITION

Operating temperature: – 25 °C ... + 65 °C

CERTIFICATE

REACH: REACH compliant

RoHS: RoHS compliant

OTHER

Short Description: Actuator, 19 mm x 19 mm, Flush, Illuminated, Green, Plastic, translucent, Square, Black, Plastic, Soldering terminal, Green

Dimension: 13.8 mm x 13.8 mm

Product attributes: Luminosity and wave length variations caused by LED manufacturing processes may cause slight differences regarding the illumination. The customer has to decide what resistor shall be used to the LED

Wiring diagrams:



Component layouts:

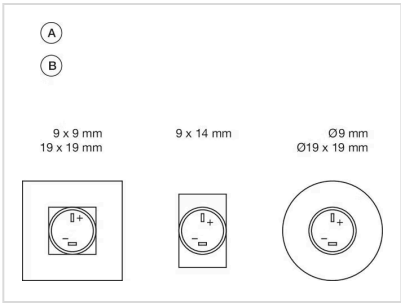

A = Terminals (rear side)
B = Indicator

Mounting cut-outs:

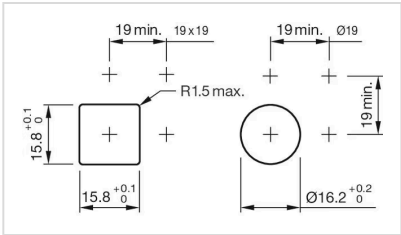

Dimension drawings:

