

Actuator

46-
2J31.15T0.000

Distribution by
Farnell



<https://farnell.eao.com/component/46-2J31.15T...>

Your product:



46-2J31.15T0.000 Actuator

Loading ...

FRONT

| | |
|------------------------------|---------------|
| Front dimension: | 58 mm x 29 mm |
| Front form: | Rectangular |
| Front bezel colour: | Black |
| Front bezel material: | Plastic |

MOUNTING

| | |
|--------------------------|----------------|
| Design: | Raised |
| Mounting cut-out: | Ø 22.3 mm |
| Mounting type: | Panel mounting |

OPERATING-/INDICATION PART

| | |
|---------------------------|------------------------|
| Lens colour: | Green-red |
| Lens material: | Plastic |
| Lens illumination: | Non illuminated |
| Lens shape: | Flush |
| Lens optics: | opaque |
| Lens type: | Level with front bezel |

ELECTRICAL CHARACTERISTICS

| | |
|--------------------------|----|
| Protection class: | II |
|--------------------------|----|

MECHANICAL CHARACTERISTICS

Switching action: Momentary
Mechanical lifetime: 1 Mil. cycles of operation
Tightening torque: 2 ... 3 Nm (17.7 ... 26.6 Lb-in)
Weight: 0.025 kg

AMBIENT CONDITION

IP front protection: IP65
IK front protection: IK03
Operating temperature: - 25 °C ... + 55 °C
Shock resistance: 30g, 18ms (EN-IEC 60068-2-27)
50g, 11ms (EN-IEC 60068-2-27)
Vibration resistance: 5g f= 2...500Hz (EN-IEC 60068-2-6)
Climate resistance: +25°C-97%RH / +45°C-93%RH (IEC-EN60068-2-30)

CERTIFICATE

Approbations: CSA, EAC, UL
Conformities: CE
REACH: REACH compliant
RoHS: RoHS compliant
Standards: CSA C22-2, IEC EN 60947-1, IEC EN 60947-5-1, UL508

OTHER

Short Description: Actuator, Ø 22.3 mm, 58 mm x 29 mm, Flush, Non illuminated, Green-red, Plastic, opaque, Rectangular, Black, Plastic, Momentary, IP65, IK03
Housing colour: Black
Housing material: Plastic
max. number of switching elements: 8
Mounting cut-outs:

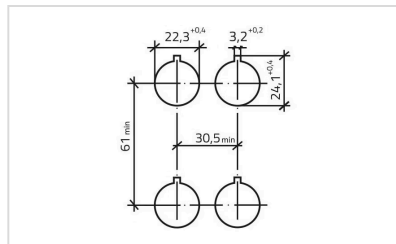

Dimension drawings:

