

Switching element - Not recommended for new design

Distribution by
Farnell

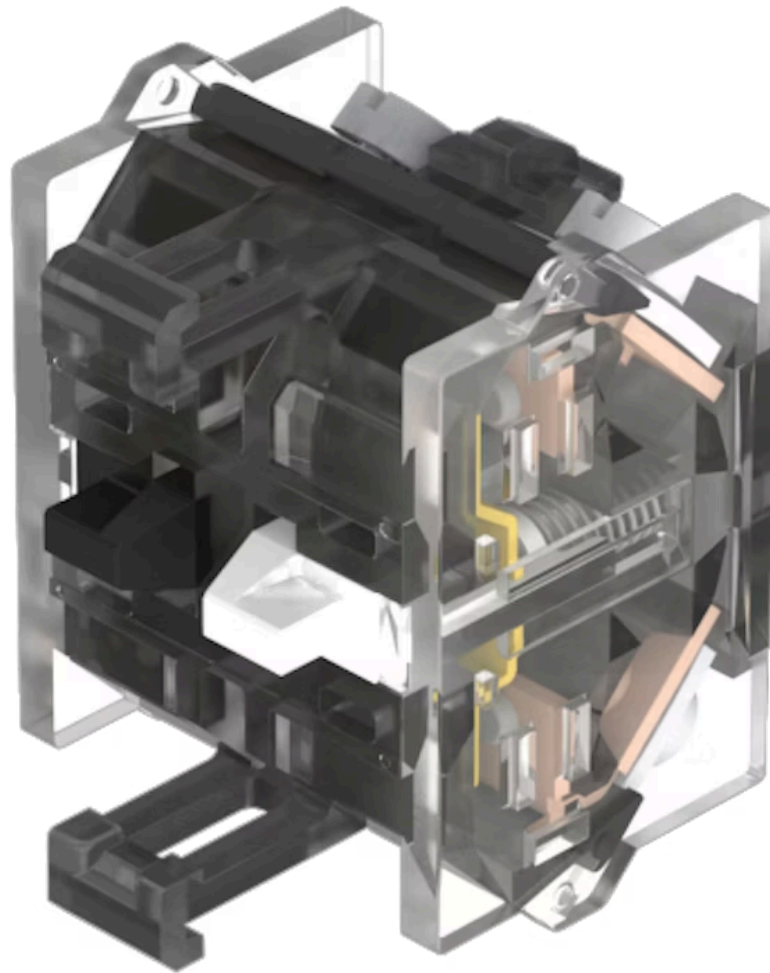

704.910.3



<https://farnell.eao.com/component/704.910.3/e...>

Your product:



704.910.3

Switching element - Not recommended for new design

PRODUCT RANGE

Product Status:

Not Recommended for new design

successor product:

<https://www.eao.com/c/704.910.3-1>

ELECTRICAL CHARACTERISTICS

Switching voltage and switching current:

| | | |
|-----------------------------|-------------------|-------|
| as per DIN EN IEC 60947-5-1 | | |
| voltage | DC13 | AC15 |
| 24 V | 4.0 A | 8.0 A |
| 60 V | 1.5 A | 8.0 A |
| 110 V | 1.0 A | |
| 120 V | | 8.0 A |
| 230 V | 0.4 A | 7.0 A |
| 400 V | 0.2 A | 5.0 A |
| 500 V | 0.15 A | 4.0 A |
| as per UL 60947-5-1 | | |
| voltage | power | |
| 24 VDC | 4.0 A, Pilot duty | |
| 60 VDC | 1.5 A, Pilot duty | |
| 120 VDC | 1.0 A, Pilot duty | |
| 240 VDC | 0.4 A, Pilot duty | |
| 415 VDC | 0.2 A, Pilot duty | |
| 480 VDC | 0.14A, Pilot duty | |
| 120 VAC | 8.0 A, Pilot duty | |
| 240 VAC | 7.0 A, Pilot duty | |
| 415 VAC | 5.0 A, Pilot duty | |
| 480 VAC | 4.0 A, Pilot duty | |

For voltages greater than $U_e = 400$ V, the grid dimensions must not be less than 35 mm x 50 mm.

Contacts:

2 NO

Rated impulse withstand voltage U_{imp} :

4 kV, according to EN/IEC 60947-5-1

Rated insulation voltage U_i :

500 V

Recommended minimum operational data:

| | | |
|----------------------|--------|---------|
| Gold-silver contacts | | |
| Voltage | 24 VDC | 110 VDC |
| Current | 5 mA | 2 mA |
| Hard silver contacts | | |
| Voltage | 24 VDC | 110 VDC |
| Current | 50 mA | 10 mA |

Switching rating:

500 V AC @ 10 A

| | |
|--|--|
| Electrical lifetime: | 50 000 cycles of operation |
| Pollution degree: | 3 |
| Standards: | The switches comply with the "Standards for low-voltage switching devices" EN IEC 60947-5-1 |
| Thermal current I_{th}: | 10 A Max. permissible current for continuous operation and ambient temperatures not exceeding the specified max. values. |

MECHANICAL CHARACTERISTICS

| | |
|----------------------------|---|
| Terminal: | Screw terminal |
| Contact material: | Silver |
| Switching system: | Slow-make switching element |
| Switching system: | The double-break, slow-make switching element is equipped with one or two independent contact systems, acting as normally open or normally closed contact. The normally closed contact has forced opening. Slow-make contacts with forced action are ideal for high switch ratings. |
| Operating force: | 1 Normally closed approx. 2 N, 1 Normally open approx. 3 N |
| Tightening torque: | Screw terminal 0.5 Nm |
| Wire cross section: | Max. wire cross-section 2 mm x 2.5 mm ² Skinning wire 10 mm Max. wire cross-section of stranded cable 2 x 1.5 mm ² use stranded wires only with wire end ferrules of 10 mm length Only one polarity is allowed on each side when wiring. |
| Weight: | 0.026 kg |

AMBIENT CONDITION

| | |
|-------------------------------|--|
| IP Protection: | IP20 |
| Operating temperature: | - 40 °C ... + 55 °C |
| Storage temperature: | - 40 °C ... + 85 °C |
| Shock resistance: | 300 m/s ² , pulse width 11 ms, 3-axis, (single impacts, semi-sinusoidal as per DIN EN 60068-2-27) |
| Vibration resistance: | 100 m/s ² at 10 Hz ... 500 Hz, amplitude 0.75 mm, (sinusoidal according to DIN EN 60068-2-6) |
| Climate resistance: | Relative humidity, max. 95%, non-condensing |

CERTIFICATE

| | |
|----------------------|---|
| Approbations: | CB (IEC 60947-5-1), cULus, DNV, EAC, NFF, VDE |
| Conformities: | CE, CCC, UKCA |
| REACH: | REACH compliant |

RoHS: RoHS compliant

OTHER

Short Description: Switching element - Not recommended for new design, Slow-make switching element, 500 V AC @ 10 A, Silver, 2 NO, Screw terminal

Hints: When using the switching element, the application guidelines must be observed. For the third switching element the terminal marking insert is to be ordered separately
Operating temperature: Other temperatures on request

Special requirements: Special requirements for positive-opening auxiliary current switches
Positive opening travel
Minimum force
Max. travel

Emerg
Emerg
which i
Emerg

Wiring diagrams:

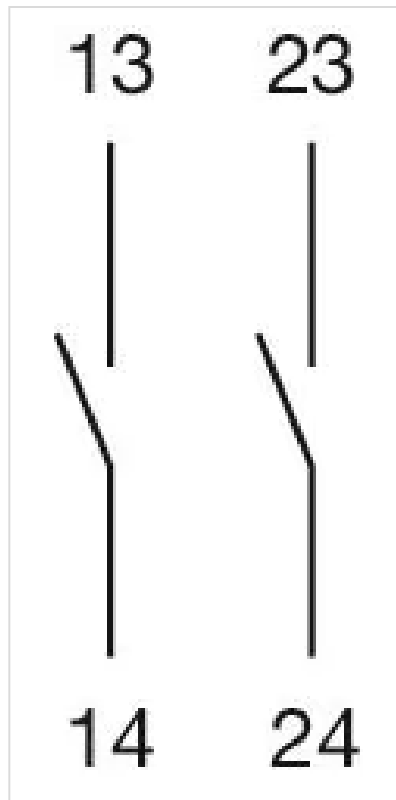

Dimension drawings:

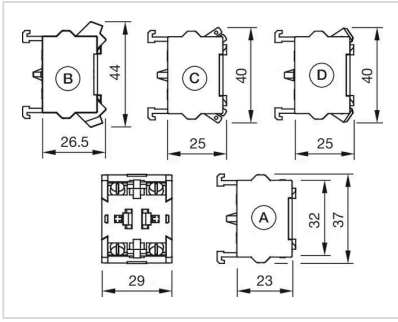

- A = Screw terminal
- B = Push-in terminal (PIT)
- C = Plug-in terminal 6.3 mm x 0.8 mm
- D = Double plug-in terminal 6.3 mm x 0.8 mm