

Illuminated pushbutton Ø 19 mm silver contact

82-5152.1123.B001

Distribution by
Farnell



<https://farnell.eao.com/p/82-5152.1123.B001>

Your product:



82-5152.1123.B001

Illuminated pushbutton Ø 19 mm silver contact

FRONT

| | |
|-----------------------|-----------------|
| Front dimension: | Ø 22 mm |
| Front form: | Round |
| Front bezel material: | Stainless steel |
| Front bezel shape: | Flush |

MOUNTING

| | |
|-------------------|----------------|
| Mounting cut-out: | Ø 19 mm |
| Mounting type: | Panel mounting |

OPERATING-/INDICATION PART

| | |
|------------------------|-----------------|
| Lens colour: | Silver |
| Lens material: | Stainless steel |
| Lens illumination: | Illuminated |
| Lens shape: | Flush |
| Lens optics: | opaque |
| Symbol: | ON/OFF |
| Illumination colour: | Blue |
| Shape of illumination: | Ring |

ELECTRICAL CHARACTERISTICS

Switching voltage and switching
current:

| | |
|--|---------------------|
| according to IEC 60947-5-1 (Silver contacts) | |
| Service categorie AC-15 | |
| Voltage | Current |
| 24 VAC | 1 A |
| 35 VAC | 1 A (M12 version) |
| 110 VAC | 1 A |
| 220 VAC | 0.5 A |
| Switch rating DC service categorie DC-13 (Silver contacts) | |
| Voltage | Current |
| 24 VDC | 0.7 A |
| 35 VDC | 0.5 A (M12 version) |
| 110 VDC | 0.2 A |
| 220 VDC | 0.1 A |

| | |
|---------------------------------------|---------|
| according to UL 508 (Silver contacts) | |
| cosφ 0,75 ... 0,8 | |
| Voltage | Current |
| 120 VAC | 5 A |
| 240 VAC | 3 A |
| 24 VAC | 1 A |

| | |
|--------------------------------------|--|
| Contacts: | 1 C |
| Operating voltage: | 12 V AC/DC |
| Operation current: | 7 mA |
| Rated Operational Voltage Ue: | 250 VAC |
| Rated insulation voltage Ui: | 250 V |
| Switching rating: | 240 V |
| Electrical lifetime: | 50 000 cycles of operation |
| Electric strength: | 1500 VAC, 50 Hz 1 minute between life terminals and ground |
| Pollution degree: | 2, according to EN IEC 60947-1 |
| Thermal current Ith: | 5 A |

MECHANICAL CHARACTERISTICS

| | |
|-----------------------------|---------------------------------------|
| Terminal: | Screw terminal |
| Contact material: | Silver |
| Switching action: | Momentary |
| Switching system: | Snap-action switching element |
| Mechanical lifetime: | 1 Mil. cycles of operation |
| Operating force: | 4 N ... 7 N |
| Operating Travel: | ca. 3 mm |
| Tightening torque: | 0.5 ... 0.6 Nm, Screw terminal 0.1 Nm |
| Weight: | 0.018 kg |

AMBIENT CONDITION

| | |
|-------------------------------|--|
| IP front protection: | IP65, IP67 |
| Operating temperature: | – 30 °C ... + 70 °C |
| Storage temperature: | – 40 °C ... + 80 °C |
| Shock resistance: | Max. 500 m / s ² as per IEC 60068-2-27 |
| Vibration resistance: | 10 ... 500 Hz, amplitude 1.5 mm p-p according to IEC 60068-2-6 |
| Climate resistance: | Damp heat, 21 days according to IEC 60512-11 |

CERTIFICATE

| | |
|----------------------|---|
| Approbations: | CB, CCC, C UL, UL |
| Conformities: | CE, 2011 / 65 / EC (RoHS), 2014 / 35 / EU (LVD) |
| REACH: | REACH compliant |
| RoHS: | RoHS compliant |

OTHER

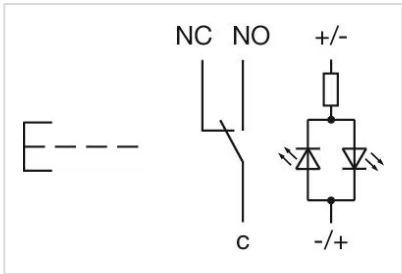
| | |
|------------------------------|--|
| Short Description: | Illuminated pushbutton Ø 19 mm silver contact, Momentary, 240 V, 12 V AC/DC, 1 C, Screw terminal, Round, Stainless steel, Blue, ON/OFF, Silver |
| Kind of illumination: | Single-LED |
| Wiring diagrams: |  |

Component layouts:



Mounting cut-outs:

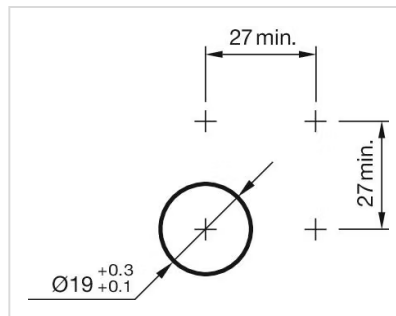

Dimension drawings:

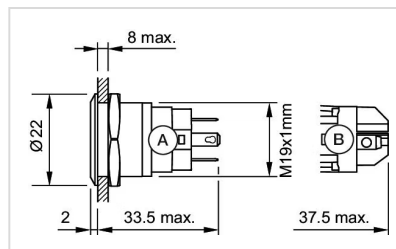

A = Solder terminal
B = Screw terminal